

QUADRO DE QUANTIDADES	
CAIXA C/ GRELHA DUPLA (FERRO FUNDIDO)	3 und
REDE DE Ø400mm	9,00 m
REDE DE Ø600mm	53,00 m
POÇO DE VISITA	3 und
CAIXA COLETORA	1 und
BOCA P/ BUEIRO	1 und
STCC 60-15	55,00 m
DISSIPADOR DE ENERGIA	1 und

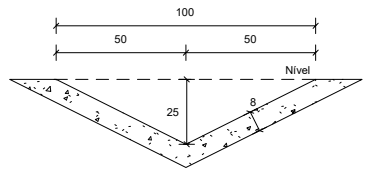

Consumos médios ³		Método executivo ⁴	
		Convencional	Extrusão
Concreto fck ≥ 20 MPa	m³/m	0,1054	0,1054
Guia de madeira	m/m	0,7590	-
Argamassa de cimento e areia ⁶	m³/m	0,0001	-

STCC 100-25
SEM ESCALA

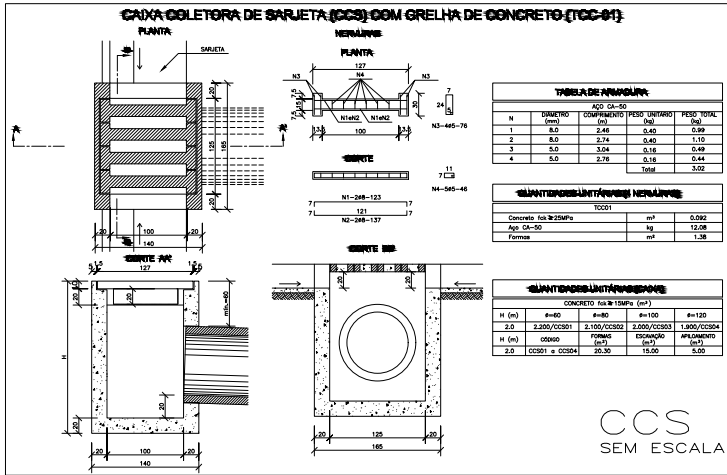
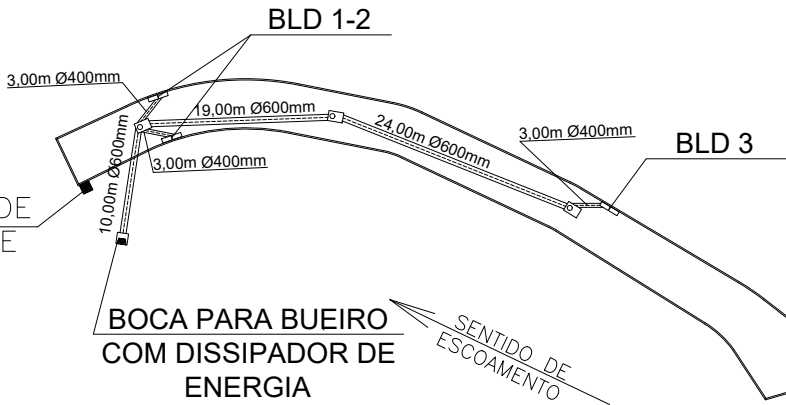
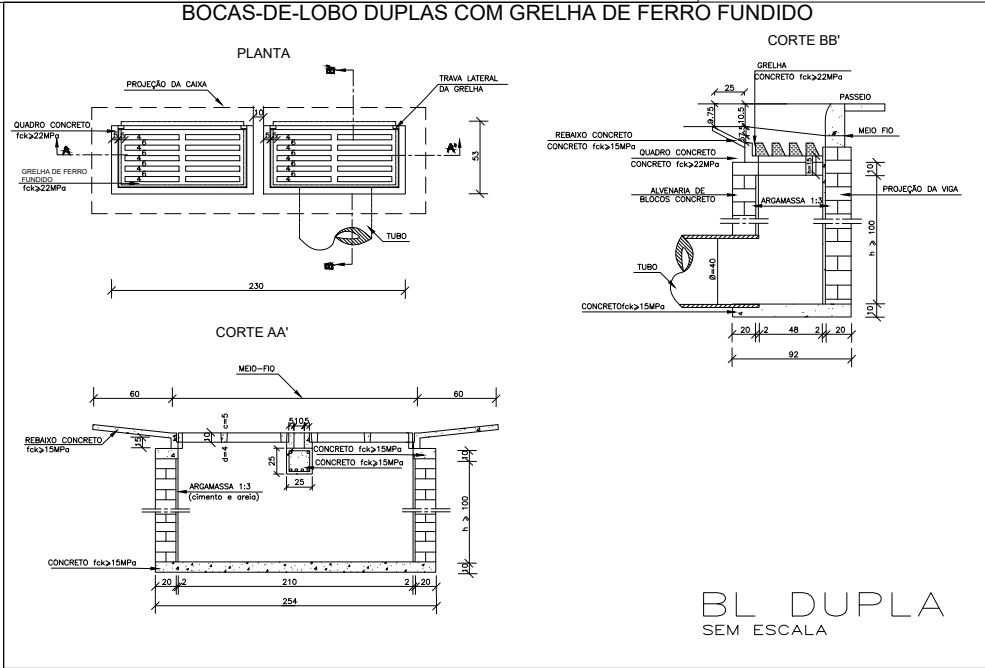
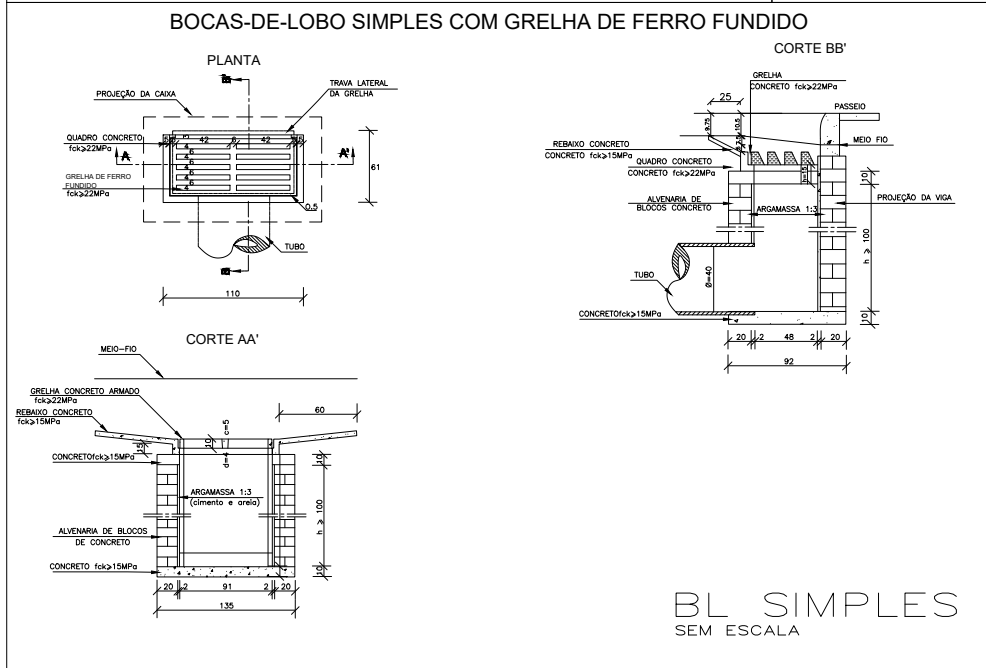
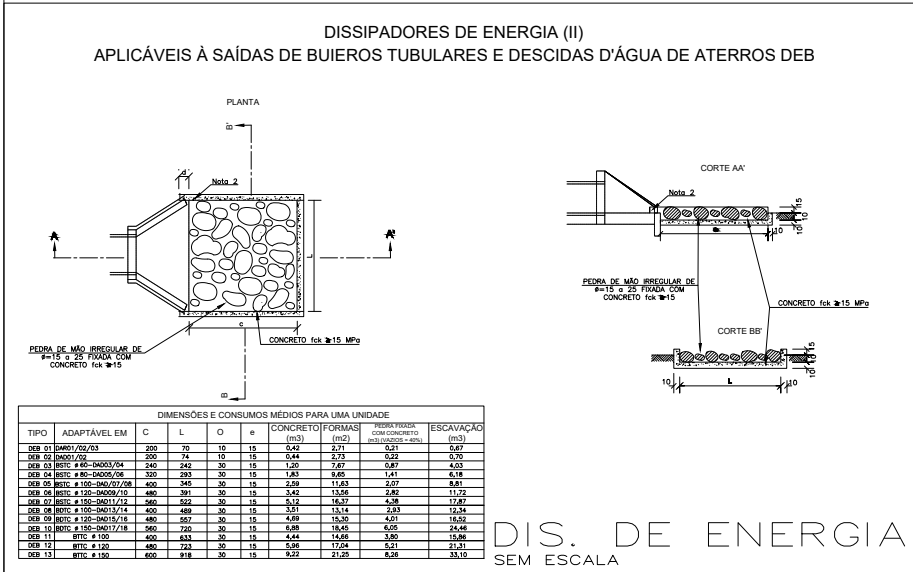
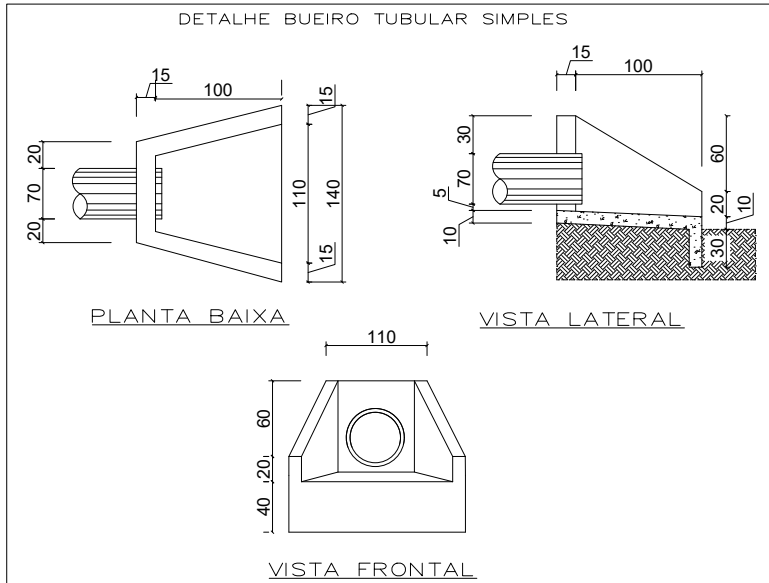

SARJETA TRIANGULAR DE CONCRETO 60-15
L = 55M

DRENAGEM
1: 750

TÍTULO: PAVIMENTAÇÃO DA RUA JOAQUIM SABINO DA SILVA		FORMATO: A3	
ENDEREÇO: TABAJARA - INHAPIM-MG		PRANCHA: 02/02	
PROP: _____ CNPJ 20.905.865/0001-04 PREFEITURA MUNICIPAL DE INHAPIM			
RESP. TEC. _____ CREA: 240.713/D CAIO HENRIQUE DA SILVA CARVALHO ENGENHEIRO CIVIL			
OBS: DRENAGEM E DEMAIS DISPOSITIVOS			
ESCALA: INDICADAS	ART: MG20264665968	DATA: 02/2026	DES: